

NEW!

CoolAnchor

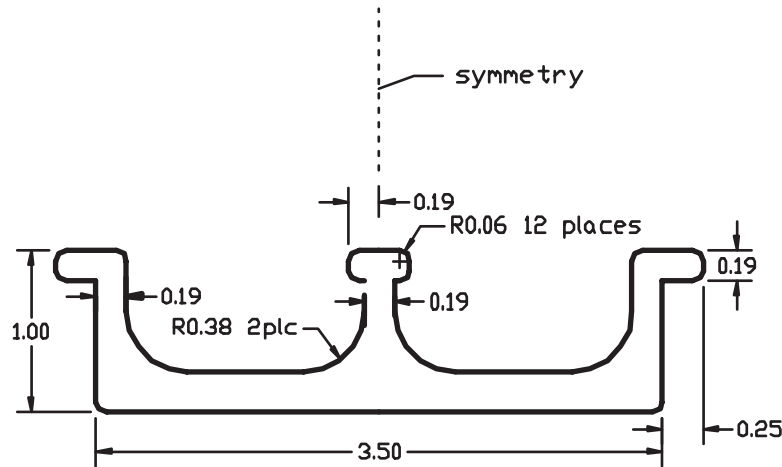

CoolAnchor is a new anchoring system, engineered for use wherever a polypropylene liner and concrete are used together.

CoolAnchor is a continuously extruded product, uniquely designed to keep liners securely in place. CoolAnchor provides cost and labor savings while increasing the durability of a variety of containment projects.

CoolAnchor will also give your project a more professional “finished” look .

Contact a Cooley Representative for more information about this exciting new product!